

EX14N Extreme Environment Integrated Day/Night Cameras

www.boschsecurity.com



BOSCH
Invented for life



- ▶ Weatherproof design for hot, cold and wet environments
- ▶ 12 m (40 ft) of active infrared night vision
- ▶ Photocell-controlled operation for accurate switching
- ▶ Injection molded ABS-Nylon resin enclosure, IP66
- ▶ Completely insulated internal chamber

The EX14N is an all-environment Integrated Day-Night (IDN) camera for extreme weather applications. The simple, effective design allows performance in the most challenging of environmental conditions. The housing is compact, yet large enough for a 9 to 22 mm varifocal lens, the mechanical filter imaging technology and integrated infrared illumination for 12 m (40 ft) Night Vision.

The EX14N incorporates mechanical filter technology for vivid daytime color and exceptional night-time imaging under infrared illumination while maintaining sharp focus under all lighting conditions. The EX14N also features proprietary CCD technology for outstanding spectral response in the near infrared for excellent active-infrared night vision.

A high-efficiency 18-LED spatially optimized infrared array contributes to evenly-distributed infrared illumination. Photocell-control ensures that video and LED switching are accurate. The result is an excellent 24/7 camera, with 40 ft of Night Vision in totally dark environments.

Made of an injection-molded ABS/Nylon resin, the EX14N series is engineered specifically to withstand hot, cold and wet environments. A totally insulated

inner chamber eliminates the requirement for internal heaters and blowers. Compliant to IP66, the EX14N series also features an easy-access camera compartment for easy camera/lens adjustments and installation.

Rugged, compact, power protected and extreme weather-sealed, the EX14N Series is an ideal IDN camera for extreme environments in day or dark conditions. The EX14N is available with a varifocal 4 to 9 mm auto-iris lens and comes complete with a nylon wall bracket for quick and easy installation.

Functions

The camera features:

- Totally weatherproof for hot and cold environments
- Completely insulated internal chamber
- No requirement for internal heater or cooler
- Installer-friendly, easy-access camera compartment
- Varifocal 4 to 9 mm auto-iris lens
- Extreme weather sealed, water resistant and IP66 compliant
- Photocell-controlled operation for accurate switching

Applications

- Wash down applications
- Food processing
- Marine applications
- Artic conditions
- Acid / alkali environment
- Sewage Treatment plants
- Sub-zero weather applications
- Coastal environments
- Chemical facilities
- Ports and harbors
- Cruise ships
- Industrial freezers and refrigerators

Certifications and approvals

Region	Certification
Europe	CE

Installation/configuration notes

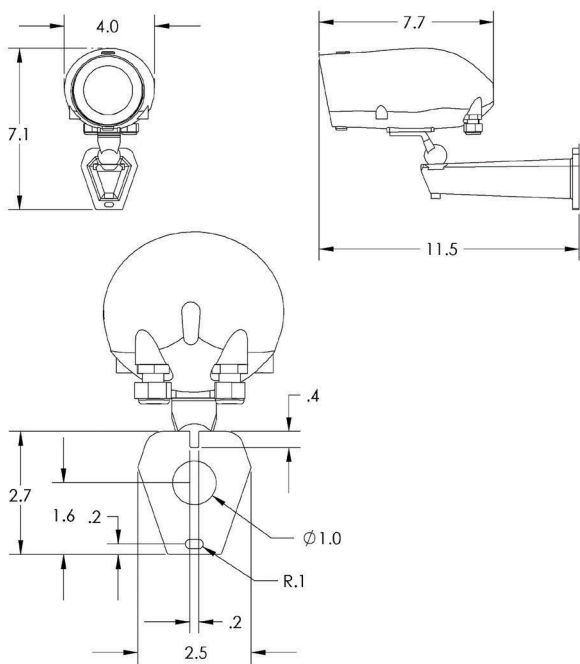

Technical specifications

Model	EX14MNX
CCD	MX4 with Mechanical Filter
Image Sensor	1/3 in CCD
Resolution	540 TVL color 540 TVL monochrome
Effective Pixels	NTSC: 768 x 494 (HxV) PAL: 752 x 582 (HxV)
Daytime	0.02 lux with F1.4 lens
Night time	0 lux with infrared (B/W)

S/N Ratio	Greater than 48 dB (AGC off)
Video Output	1 Vpp, 75 ohm
Gamma	0.45
Gain Control	AGC (with on/off switch)
Electronics Iris	1/60 to 1/100,000 (NTSC) 1/50 to 1/100,000 (PAL)
Voltage Supply	12 to 24 AC/DC
LED Type	High-efficiency 850nm, even distribution IR
Number of LEDs	18
Power Consumption	4.5 W
Internal Heater / Cooler	Not Required
Window	Flame resistant VO-Margard; 50 mm (2.0 in)
Wall Bracket	Included
Color	Black standard
External Dimensions	180 x 85 x 85 mm (L x W x H) 7.1 x 3.3 x 3.3 in (L x W x H)
Window Diameter	50 mm (2.0 in)
Weight	0.7 kg (1.5lb) bracket included
Temperature Range Operation	-60°C to +60°C (-76°F to +140°F)
Environmental	IP66 compliant

Ordering information

EX14MNX8V0408B-N Extreme Environment Integrated Day/Night Camera

1/3 in. extended day/night, 540/540 TVL, 18LED 850 nm, 4-9 mm lens, NTSC
Order number **EX14MNX8V0408B-N**

EX14MNX8V0408B-P Extreme Environment Integrated Day/Night Camera

1/3 in. extended day/night, 540/540 TVL, 18LED 850 nm, 4-9 mm lens, PAL
Order number **EX14MNX8V0408B-P**

Accessories

EXPS.008 VAC Power Supply

Power supply 120 VAC/ 24 VAC 1500 mA
Order number **EXPS.008**

PSU-230-24 Power Supply

Power Supply, 230 VAC / 24 VAC, 50 W
Order number **PSU-230-24**

Represented by:

Americas:

Bosch Security Systems, Inc.
130 Perinton Parkway
Fairport, New York, 14450, USA
Phone: +1 800 289 0096
Fax: +1 585 223 9180
security.sales@us.bosch.com
www.boschsecurity.us

Europe, Middle East, Africa:

Bosch Security Systems B.V.
P.O. Box 80002
5617 BA Eindhoven, The Netherlands
Phone: + 31 40 2577 284
Fax: +31 40 2577 330
emea.securitysystems@bosch.com
www.boschsecurity.com

Asia-Pacific:

Robert Bosch (SEA) Pte Ltd, Security
Systems
11 Bishan Street 21
Singapore 573943
Phone: +65 6571 2808
Fax: +65 6571 2699
apr.securitysystems@bosch.com
www.boschsecurity.asia

China:

Bosch (Shanghai) Security Systems Ltd.
201 Building, No. 333 Fuquan Road
North IBP
Changning District, Shanghai
200335 China
Phone +86 21 22181111
Fax: +86 21 22182398
www.boschsecurity.com.cn

America Latina:

Robert Bosch Ltda Security Systems Division
Via Anhanguera, Km 98
CEP 13065-900
Campinas, Sao Paulo, Brazil
Phone: +55 19 2103 2860
Fax: +55 19 2103 2862
latam.boschsecurity@bosch.com
www.boschsecurity.com