

DDZ4020-YY/HS/HD DOMERA®

High-Speed IP Network PTZ Dome Camera, Full HD, 1080p/30, 20× Optical Zoom, Auto-focus, Wide Dynamic Range, Day/Night, PoE+

DOMERA® High-Definition



DOMERA® High-Definition HS is a modular Full HD high-speed PTZ dome camera system.

The high-resolution IP network PTZ dome camera DDZ4020-YY/HS/HD with 20× optical zoom, auto-focus, Wide Dynamic Range and Dallmeier Cam_inPIX® technology provides real-time Full High-Definition video and is available in three mounting variants (in-ceiling mount, surface mount, weather-proof).

Features

- 1/3" Full HD CMOS image sensor with Cam_inPIX® technology
- Pure Digital Signal Processing
- High-speed PTZ dome
- 20× optical zoom
- 12× digital zoom
- ICR¹⁾ function for Day/Night switching
- Comprehensive set of image optimization functions like AWB, AGC, BLC and Slow Shutter
- Auto-focus with manual override
- Wide Dynamic Range (WDR)²⁾
- Digital Noise Reduction (DNR)
- Resolution: SD (NTSC/PAL), HD (up to 1080p/30)
- Video compression: H.264, MJPEG
- Frame rate up to 60 fps³⁾
- Simultaneous Dual-Streaming (video compression, resolutions, frame and bit rates of each stream independently adjustable)
- Privacy Zone Masking (hiding/masking of up to 8 protected areas)
- Motion detection⁴⁾ with selectable sensitivity
- Alarm notification via DaVid protocol, e-mail and FTP image upload
- Bidirectional audio (intercom)
- Local video memory⁴⁾ (USB/SDHC port)
- 64 MB RAM video buffer
- High-performance Pan/Tilt/Zoom mechanism
- 248 programmable preset positions, 16 programmable scans
- 8 programmable tours, 8 programmable pattern
- Voltage supply (PTZ camera) with PoE+ or 24/28 V AC
- Three available mounting variants (IP I/O interface integrated): in-ceiling mount (IM), surface mount (SM) or weather-proof (WM)
- Easy and quick installation
- IK10 and IP67 (weather-proof variant)
- ONVIF compliant
- DIN EN 50130-4 compliant

Variants	
000486.002717	DDZ4020-IM/HS/HD DOMERA® High-speed IP network PTZ dome camera, Full HD, 1080p/30, 20× optical zoom, WDR, in-ceiling mount variant
000487.002756	DDZ4020-SM/HS/HD DOMERA® High-speed IP network PTZ dome camera, Full HD, 1080p/30, 20× optical zoom, WDR, surface mount variant
000481.002717	DDZ4020-WM/HS/HD DOMERA® High-speed IP network PTZ dome camera, Full HD, 1080p/30, 20× optical zoom, WDR, weather-proof variant

Options	
000401	Wall Mount Bracket Indoor Black, for DOMERA® HD surface mount variant
001035	Tinted Bubble White cover ring, for DOMERA® SD/HD in-ceiling mount variant
001109	Wall Mount Bracket Outdoor White, for weather-proof housing
001111	Pole Mount Bracket Outdoor, white, for weather-proof housing
001112	Corner Mount Bracket Outdoor, white, for weather-proof housing
003847	Junction Box DJB-115W Outdoor, white, for weather-proof housing
001115	Mounting Plate Outdoor, white, for Wall Mount Bracket Outdoor (surface mounting), for Ceiling Mount Bracket (surface mounting), for Junction Box DJB-115W (corner and pole mounting)
001116	Roof Mount Bracket⁵⁾ Swan neck, outdoor, white, for weather-proof housing
001117	Ceiling Mount Bracket Outdoor, white, for weather-proof housing
001431	EvC-1 High-Speed Ethernet data transmission via coaxial cable
002192	VMC Joystick (with 200 cm USB cable) Joystick module of the VMC-1 control panel as stand-alone device
004316	PoE+ Power Supply 1-Port 30W (Midspan)

1) ICR = IR Cut Filter Removable

2) Provides enhanced colour reproduction and detail resolution even in scenes with a wide range of contrast and strong backlighting.

3) Depending on the set resolution.

4) Function is in preparation.

5) Not compatible with item number 003847

All trademarks identified by ® are registered trademarks of Dallmeier electronic.

All trademarks identified by * are trademarks or registered trademarks of the following owners: ActiveX of Microsoft Corporation headquartered in Redmond, Washington, USA

DDZ4020-YY/HS/HD DOMERA®

High-Speed IP Network PTZ Dome Camera, Full HD, 1080p/30, 20× Optical Zoom, Auto-focus, Wide Dynamic Range, Day/Night, PoE+

Specifications

Sensor

Type	1/3" Full High-Definition CMOS image sensor with Cam_inPIX® technology
Effective pixels	Approx. 2 000 000 (2 Megapixels)
Signal processing	Pure Digital Signal Processing
Image capture	Progressive Scan
Minimum illumination	ICR ⁶⁾ Off: 0.5 lux (F1.6, 50 IRE) ICR On: 0.095 lux (F1.6, 50 IRE)
Signal to noise ratio (SNR)	More than 50 dB

Lens

Type	F1.6–F3.5/f=4.7 mm–94.0 mm (20× optical zoom)
Aperture control	Autoiris
Horizontal angle of view	At 1080p: approx. 55.4° (wide end) to 2.9° (tele end) At 720p: approx. 37.6° (wide end) to 2.0° (tele end)
Minimum object distance	10 mm (wide end) to 800 mm (tele end)

Functions

Digital zoom	12× (240× with optical zoom)
Focus control	Auto-focus (AF sensitivity: Normal, Low), One-Push AF, Manual, Infinity mode (∞), AF near limit selectable On/Off/Auto ICR function (adjustable switching threshold level) Automatic (in Night mode), Manual (using Effects setting) 1/1 to 1/10000 s (22 steps), slow shutter limit selectable Automatic (AE), Manual, Shutter Priority, Iris Priority, Bright –10.5 dB to +10.5 dB (15 steps, 1.5 dB increments) Automatic (AGC)/Manual (–3 to +28 dB, 16 steps) On (4 levels)/Off Auto (AWB), ATW, Indoor, Outdoor, Outdoor Auto, Sodium Vapor Lamp (Fix/Auto), One-Push, Manual Standard, Gamma 1, S-Curve Low, S-Curve Mid, S-Curve High On/Off Yes Hiding/Masking of up to 8 protected areas (Polygon, Block, Video Off, Mosaic) ⁸⁾ B/W (black-and-white), Negative With selectable sensitivity (5 levels) Via DaVid protocol (Dallmeier Video Protocol) to PGuard advance, e-mail, FTP image upload Contact IN status change, Contact OUT remote status change (via DaVid protocol), video signal loss PTZ alarm action, Contact OUT status change With web browser Via OSD ⁹⁾ with SMAVIA Viewing Client English, German, French, Spanish, Italian
Wide Dynamic Range (WDR)	
Day/Night switching	
Black-and-white mode	
Electronic (slow) shutter	
Exposure control	
Exposure compensation	
Gain control	
Digital Noise Reduction (DNR)	
White balance (WB)	
Gamma correction	
Backlight compensation (BLC)	
Flip function	
Privacy Zone Masking	
Effects	
Motion detection (VMD) ⁷⁾	
Alarm notification	
Alarm trigger	
Alarm actions	
Configuration IP I/O interface	
Configuration/control PTZ dome camera	
Languages	

PTZ Functions

Pan/Tilt	360° endless/0°–180°
Variable/Manual speed	Pan: max. 120°/s, Tilt: max. 120°/s (Turbo: max. 420°/s)
Preset speed	Pan: 420°/s, Tilt: 420°/s (±0.1°)
Programmable presets	248 positions with camera status (16-character title)
Programmable scans	16 scans (including diagonal scans), 1 Auto Pan (360° continuous panning) 8 8 (total up to 480 seconds) Automatic execution of stored functions (presets, scans, tours or pattern), Contact OUT status change
Programmable tours	
Programmable pattern	
Alarm actions at Contact IN status change	

Format and Encoding

Video standard	SDTV (PAL/NTSC), HDTV (SMPTE 296M, SMPTE 274M)
Resolution SD	4CIF (704 × 576), CIF (352 × 288), QCIF (176 × 144), 4SIF (704 × 480), SIF (352 × 240), QSIF (176 × 112), VGA (640 × 480), QVGA (320 × 240), 1080p (1920 × 1080), HD H (1920 × 540), HD D (1440 × 720), 720p (1280 × 720)
Resolution HD	H.264, MJPEG
Video compression	MPEG-1/2 Layer 2, G.711, G.722.1
Audio compression	Up to 60 fps at resolution SD and 720p Up to 30 fps at 1080p, HD H, HD D
Frame rate	0.25–8 Mbps, CBR (constant bit rate) or VBR (variable bit rate) 32–160 kbps (MPEG-1/2 Layer 2), 64 kbps (G.711), 16 kbps (G.722.1) Simultaneous Dual-Streaming: Video compression, resolutions, frame and bit rates of each stream independently adjustable (maximum total frame rate of all streams 30 fps with maximum resolution)
Video bit rate	Progressive (full image)
Audio bit rate	Unicast, Multicast
Video streaming	
Transfer format	
Live streaming transmission method	

6) ICR = IR Cut Filter Removable
7) Function is in preparation.

8) Repeated mask positioning in the image can differ slightly from the stored original position depending on the zoom factor or positioning speed.
9) OSD = On Screen Display

DDZ4020-YY/HS/HD DOMERA®

High-Speed IP Network PTZ Dome Camera, Full HD, 1080p/30, 20× Optical Zoom, Auto-focus, Wide Dynamic Range, Day/Night, PoE+

Interfaces

Audio IN (stereo)	1× 3.5 mm phone jack (Line IN)
Audio OUT (stereo)	1× 3.5 mm phone jack
Contact IN	3×
Contact OUT	1×
Serial interface	1× RS485 (full duplex, half duplex)
Local video memory	USB/SDHC port integrated ¹⁰⁾ (adapter for SDHC card separately available)
Ethernet	1× RJ45, 10BASE-T/100BASE-TX-PoE

Protocols

Ethernet protocols	IPv4, TCP, UDP, ARP, ICMP, DHCP, NTP, HTTP, RTSP, IGMP V2, FTP, SMTP, RTP, RTCP
SNMP support	Yes
PTZ control protocols	Dallmeier DCCP, Pelco D

Miscellaneous

Video buffer	64 MB RAM ring storage (pre- and post alarm, network failure compensation)
Programming interface	Open platform for integration into third-party systems using API and ActiveX*
ONVIF compliance	Core Specifications 1.01 & 1.02

Electrical Data

Voltage supply	PTZ camera: Power supply unit 1 with 24/28 V AC ±10% (50/60 Hz) or via PoE+ ¹¹⁾
PoE standard	Fan/heater (weather-proof housing): Power supply unit 2 with 24 V AC (50/60 Hz), max. 3 A
Power consumption	IEEE 802.3at In-ceiling mount variant: max. 25 W Surface mount variant: max. 25 W Weather-proof variant: max. 25 W (max. 89 W with fan/heater)

Mechanical Data

Dimensions	In-ceiling mount variant: approx. Ø 227 × H 248 mm (Ø 8.94 × H 9.76 inches) Surface mount variant: approx. Ø 166 × H 244 mm (Ø 6.54 × H 9.61 inches) Weather-proof variant: approx. Ø 258.5 × H 330 mm (Ø 10.18 × H 12.99 inches)
Weight	In-ceiling mount variant: approx. 2025 g (4.46 lb) Surface mount variant: approx. 1755 g (3.87 lb) Weather-proof variant: approx. 4425 g (9.76 lb)
Colour	In-ceiling mount variant: black housing, white cover ring Surface mount variant: black Weather-proof variant: white
Bubble	Clear
Vandal-resistant	Yes (weather-proof variant)
IK protection	IK10 protection against external mechanical impacts (up to 20 joules, weather-proof variant)
IP rating	IP67 (weather-proof variant)

Fan/heater (weather-proof housing)

Fan/heater	On: ≤ +5°C (±3°C), Off: ≥ +10°C (±3°C); On: ≤ 41°F (±5°F), Off: ≥ 50°F (±5°F)
------------	---

Environmental Conditions

Operating temperature	In-ceiling mount variant (indoor): -10°C to +40°C (14°F to 104°F) Surface mount variant (indoor): -10°C to +40°C (14°F to 104°F) Weather-proof variant (outdoor): -40°C to +50°C (-40°F to 122°F) (minimum start-up temperature: -30°C/-22°F)
Relative humidity	0%–90% RH, non-condensing

Approvals/Certifications

Type	CE, FCC, UL, ACA, UVV “Kassen” (DGVU Test), CB, DIN EN 50130-4 compliant
------	--

¹⁰⁾ Function is in preparation.

¹¹⁾ LLDP-capable PoE+ switch mandatory

All trademarks identified by ® are registered trademarks of Dallmeier electronic.

All trademarks identified by * are trademarks or registered trademarks of the following owners: ActiveX of Microsoft Corporation headquartered in Redmond, Washington, USA

DDZ4020-YY/HS/HD DOMERA®

High-Speed IP Network PTZ Dome Camera, Full HD, 1080p/30, 20× Optical Zoom, Auto-focus, Wide Dynamic Range, Day/Night, PoE+

Dimensions

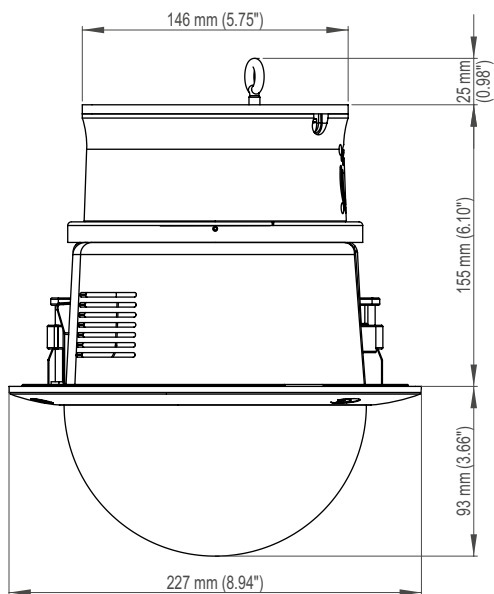

Fig. 1: In-ceiling mount variant

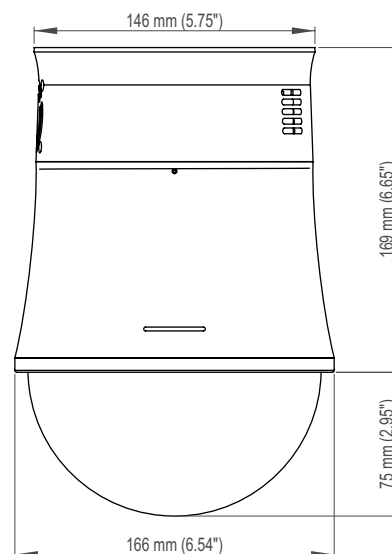

Fig. 2: Surface mount variant

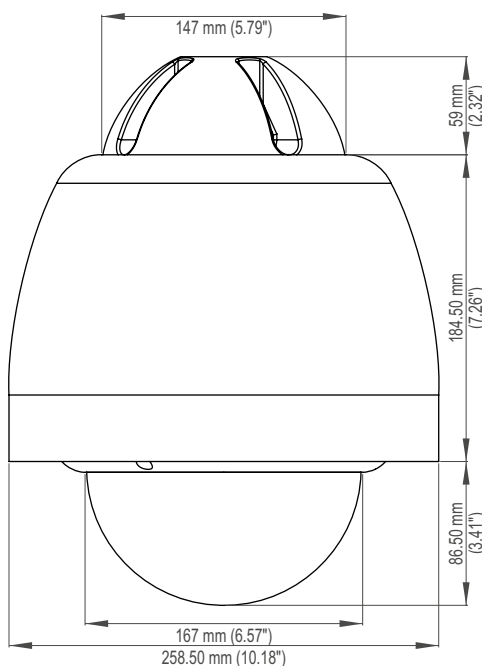
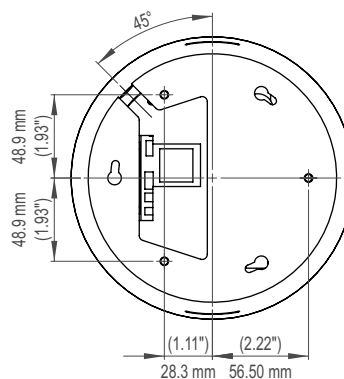
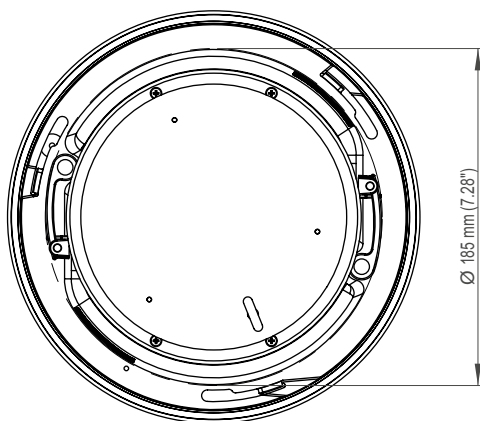

Fig. 3: Weather-proof variant