

PTH355P

OUTDOOR VARIABLE SPEED P&T MOTOR

MAIN FEATURES

Constructed from corrosion-proof aluminium

For loads up to 12kg(26lb) balanced

DC motors: (24Vdc)

Controlled by the DTRXDC telemetry receiver

Preset function

Internally adjustable horizontal and vertical limit switches

Horizontal speed 30°/s, vertical 18°/s

DESCRIPTION

The PTH355P P & T motor is constructed from aluminium protected by epoxy polyester painting RAL9002. It allows a maximum horizontal speed of 30°/s, a maximum vertical speed of 18°/s and a horizontal rotation of 345°, vertical 360°. Available in 24Vdc.

It is possible to utilize the preset functions by the telemetry systems and the PTH355P can be easily controlled through DCJ keyboard with the specific telemetry receiver DTRXDC.

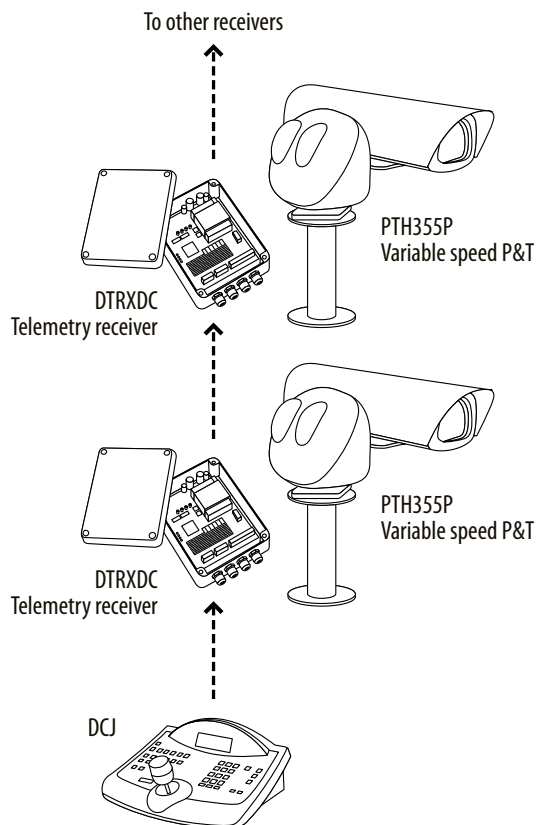

AVAILABLE MODELS

Model Number	Power supply	Autopan	Preset	Consumption max
PTH355P	24Vdc	-	✓	22W

The P&T motor is not suitable for continuous use in autopan

----> Twisted pair RS485 (max distance 1200m / 3937ft) telemetry only

TECHNICAL DATA

GENERAL

Constructed from corrosion-proof aluminium
 Epoxypolyester powder painting, RAL9002 colour
 Stainless steel external screws
 Mounting position normal/reverse
 Supplied with side bracket for camera housing and accessories for mounting
 Standard Preset

MECHANICAL

Dimensions: 144x161x180mm (5.6x6.3x7in)
 Load rating: 12kg / 26.5lb max (balanced)
 Horizontal rotation: 0-345°
 Horizontal speed: 30°/s
 Pan Torque: 6Nm
 Horizontal limit switches, internally adjustable
 Vertical plane movement: 0-360°
 Tilt speed: 18°/s
 Vertical torque: 6Nm
 Backlash: Pan 0.16°, Tilt 0.15°
 Vertical limit switches, internally adjustable
 Cable glands: 2xPG11
 Unit weight: 3.6kg (7.9lb)

ELECTRICAL

Power supply 24Vdc
 Horizontal motor consumption 11W max
 Vertical motor consumption 11W max
 Potentiometer: 10kOhm, multiple rotation (10 turns, max 1 million shaft rotations)
 Max. distance to receiver DTRXDC: 15m or 5m with preset

ENVIRONMENT

Indoor/Outdoor
 Operating temperature: -20°C / +50°C (-4°F / 122°F)
 Salty fog resistance, to 1000 hours (ISO9227)

CERTIFICATIONS

Electrical safety (CE): EN60065
 Electromagnetic compatibility (CE): EN50130-4, EN61000-6-3
 IP protection degree: EN60529 (IP66)
 EAC certification

RELATED PRODUCTS

DTRXDC Telemetry data receiver, 13 functions
 Housings PUNTO, HEB, HEK, HOV, VERSO, VERSO COMPACT

BRACKETS AND ADAPTORS

PTAC Wall bracket for PTH300 series
 WFWBTA Column bracket for PTH P&T series

SPARE PARTS

OPH3MAN Maintenance kit
 DOTPTH300 Installation kit for P&T PTH300

PACKAGE

Model Number	Weight	Dimensions (WxHxL)	Master carton
PTH355P	4kg (8.8lb)	17.5x27x23cm (7x11x9in)	6

TECHNICAL DRAWINGS

Sizes in millimeters.

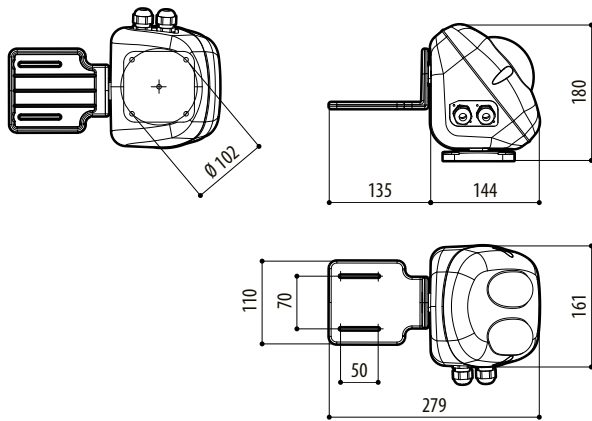

PTH355P