

# EXPTC010G

## EX-PROOF P&T MOTOR WITH HOUSING FOR THERMAL IMAGING CAMERAS



### MAIN FEATURES

Certifications Ex d for use in Zone 1 and 2, Group IIC (Gas), and in Zone Ex tb 21 and 22 (Dust)

Solid anticorrosional aluminium construction

Horizontal range 360° with speed 6°/s, vertical range -90° / +90° with speed 2.4°/s

Germanium window

Autopan function

7.5m (23ft) prewired multipolar armoured cable

Not to be installed upside down

Environment temperature: from -20°C (-4°F) up to +50°C (122°F)

### DESCRIPTION

The Pan & Tilt unit EXPTC010G is made with strong Anticorrosional aluminium, die-cast alloy of AlSi 7Mg EN - AB 42000 group. EXPTC010G is equipped with a germanium viewing window designed for thermal imaging camera installations. The germanium window composition has remarkable properties and covers transmission from 7.5 to 14µm IR range with the best optical quality. All external components are stove enamelled.

The system includes a housing with the same characteristics of the EXHC000G and a Pan & Tilt, designed for movement both horizontally and vertically. The peculiar characteristic of the device is the absence of external wiring in rotation, either for the control of the Pan & Tilt or for the camera and lens. This solution makes the installation and the maintenance of the Pan & Tilt easy. One multi-conductor cable comes out from the base of the Pan & Tilt through a cable-gland. The EXPTC010G is supplied with preset, auto-pan and housing heater and optional sunshield.

The P&T functions are controlled by the EXDTRX telemetry receiver..



EXPTC010G + EXPTS



EXDTRX324



EXDTRX3

## TECHNICAL DATA

### GENERAL

Non-corrosive die-cast aluminium (anticorrosive)  
Epoxy powder painted with orange peel effect, RAL7032

### MECHANICAL

Not to be installed upside down  
Horizontal rotation: from 0° up to 360°  
Horizontal speed (fixed): 6°/s  
Pan Torque: 2.5kgm  
Vertical plane movement: from -90° up to +90°  
Tilt speed (fixed): 2.4°/s  
Vertical torque: 6kgm  
1x Ex d 3/4" NPT IP66 ATEX cable gland for armoured cable at the base of the P&T  
Pre-wired multipolar armoured cable normally supplied with 7.5m (25ft) length: diameter 21.4mm (0.85in): 21 poles 0.5mm<sup>2</sup>, 6 poles 1.5mm<sup>2</sup>, 2 RG179, 75 Ohm  
Minimum bending radius: 10x cable diameter  
External dimensions: 427.5x571.4x560mm (16.8x322.5x22in)  
Internal dimensions: 180x380mm (7.1x15in)  
Internal usable area: 100x100x280mm (3.9x3.9x11in)  
Unit weight: 56.5kg (124.6lb)

### HOUSING'S WINDOW

Germanium window

- Usable diameter: 114mm (4.5in)
- Thick: 12mm (0.47in)
- External treatment: antiscratch (Hard Carbon Coating - DLC), antireflection
- Internal treatment: antireflection
- Spectral range: from 7.5µm up to 14µm
- Medium transmittance (from 7.5µm up to 11.5µm): 86.6%
- Medium transmittance (from 11.5µm up to 14µm): 67.8%

### ELECTRICAL

Power supply IN 24Vac, 50/60Hz  
Horizontal and vertical motor consumption: 50W max  
Standard vertical and horizontal preset potentiometers  
Heater Ton 10°C±4°C (50°F±7°F) Toff 25°C±3°C (77°F±5°F):

- IN 24Vac, consumption 20W max

Devices to install inside the housing:

- Camera equipped with lens with max total power of 20W
- Power supply max 24Vac (only for analog camera)
- Usable volume for camera/lens: 2800cm<sup>3</sup>
- Minimum distance between the walls of the housing and the camera/lens: 12mm

### ENVIRONMENT

For installation indoors and outdoors  
Operating temperature with heating: from -20°C (-4°F) up to +50°C (122°F)  
*Always refer to the temperature in the marking.*  
Relative humidity: from 10% up to 95% (no condensation)

### CERTIFICATIONS

ATEX (EN 60079-0: 2009, EN 60079-1: 2007, EN 60079-31: 2009):

- II 2G Ex d IIC T6 Gb
- II 2D Ex t IIIC T85 °C Db IP66
- 0044: notify number from competent body

EAC EX:

- Ex II 2G Ex d IIC T6 Gb, -20°C/+50°C
- Ex II 2D Ex t IIIC T85°C Db -20°C/+50°C, IP66

### ACCESSORIES

EXPTS000 Sunshield 650mm for EXPT series

### RELATED PRODUCTS

EXDTRX3 Data telemetry receiver 17 functions, 230Vac  
EXDTRX324 Data telemetry receiver 17 functions, 24Vac

### BRACKETS AND ADAPTORS

EXPTWB000 Bracket RAL7032 for EXPT series

### PACKAGE

Model Number	Weight	Dimensions (WxHxL)	Master carton
EXPTC010G	61.2kg (135lb)		76x41x67cm
(30x16x26.4in)	-		

**TECHNICAL DRAWINGS**

*The dimensions of the drawings are in millimetres.*

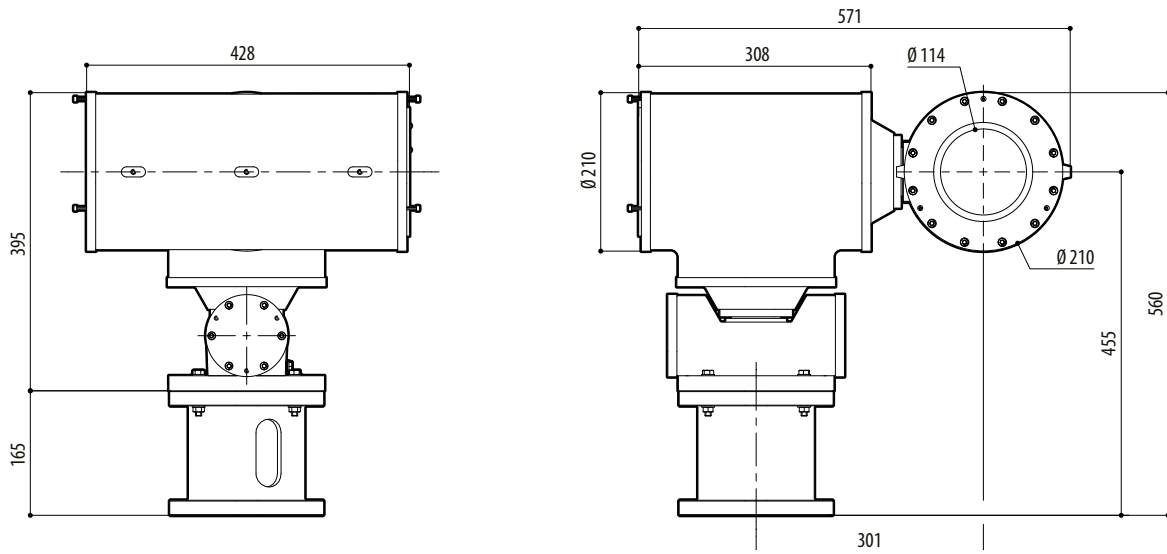

EXPTC010G